



14497

POSTED
15.5.09

Mr John Burke
Chairman
Weston Creek Community Council
PO Box 3701
WESTON CREEK ACT 2611

Dear Mr Burke

STREETON DRIVE-NAMATJIRA DRIVE CYCLE LANE

I am writing in regards to a matter that was raised at the Weston Creek Community Council General Meeting on 25 March concerning the installation of a new cycle lane on Streeton Drive and our subsequent meeting on 20 April.

Roads ACT will remove the majority of the on road cycle lane including the green lane treatment between Mulley Street and Namatjira Drive.

A bicycle lane through the intersection will be retained to enable any cyclists to safely access the left lane on Streeton Drive as they pass through the intersection.

I have included a copy of a plan showing the proposed arrangements with this letter. This work will be undertaken later in the year as part of the annual road resurfacing program, when the weather is more suitable for this type of work.

Thank you for raising this matter with me. I trust I have been of assistance.

Yours sincerely

Tony Gill

Tony Gill
Director
Roads ACT

14 May 2009

cc Refaat Shaukalleh Mrs.

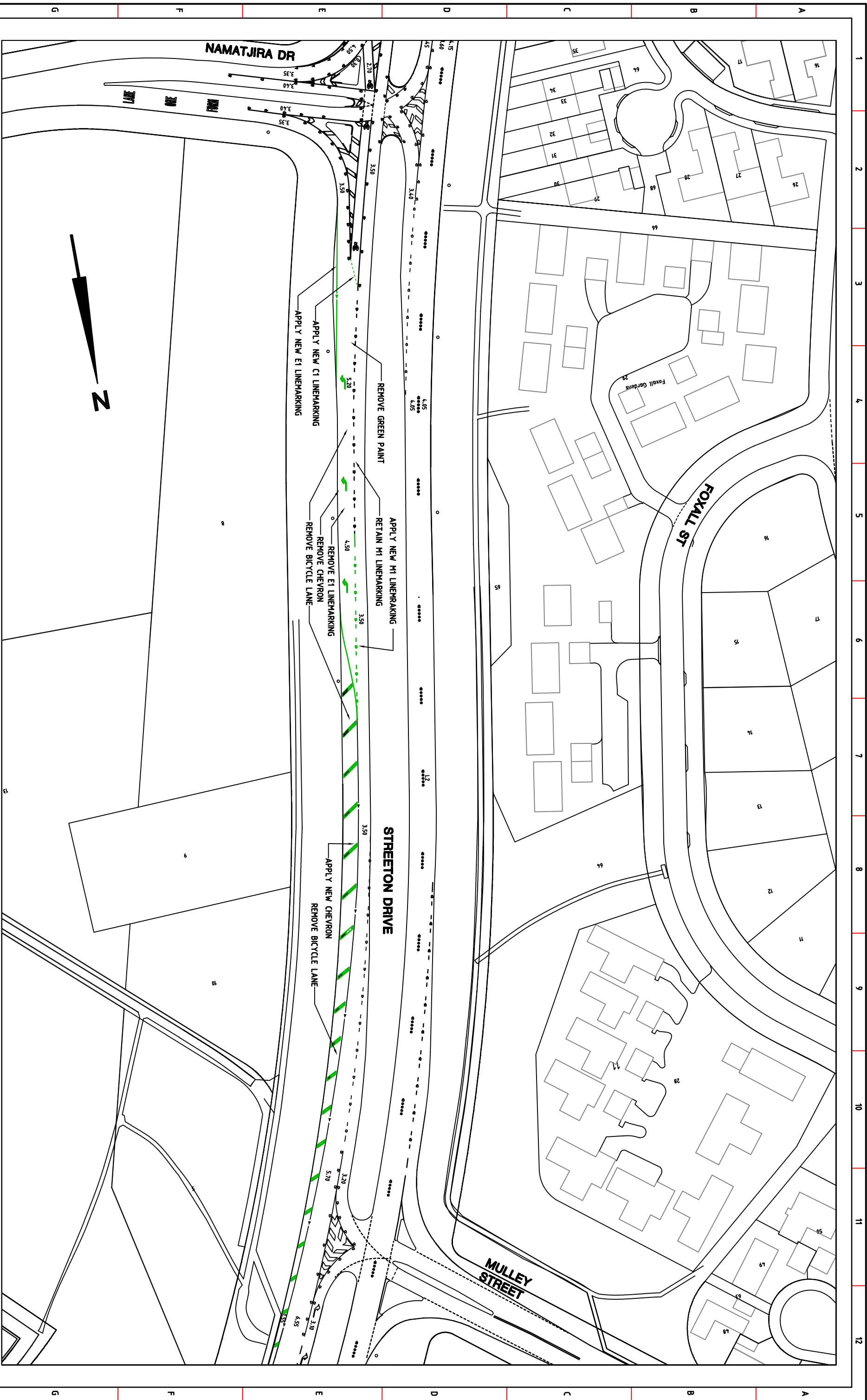

NOTE

- ALL PAVEMENT MARKINGS AND SIGN POSTING TO BE IN ACCORDANCE WITH AUSTRALIAN STANDARD AS1742 EXCEPT WHERE MODIFIED BY ACT DEPARTMENT OF URBAN SERVICES PAVEMENT MARKING & ROAD SIGN SPECIFICATIONS & ROADS ACT DESIGN STANDARD 9, TRAFFIC CONTROL DEVICE DRAWINGS.

FOR A COPY PLEASE VISIT: www.transport.nsw.gov.au/pdf/Standard_drawing.pdf

- ALL SIGNAGE INSTALLED ON ELP'S TO BE POSITIONED TO AVOID COVERING THE ELP ASSET NUMBER.

- ALL LINEMARKING TO BE WATERBOURNE PAINT UNLESS NOTED OTHERWISE. LHM DENOTES LONG LIFE MATERIAL, SUCH AS THERMOPLASTIC; TOLD APPLIED PLASTIC CEMENT BASED PRODUCTS CAPABLE OF HAVING DART APPLIED.

- ALL REDUNDANT AND/OR CONFLICTING LINEMARKING TO BE ERADICATED.

LEGEND

- ERADICATE LINEMARKING, SIGNS AND REMOVE KERB/CONCRETE.
- EXISTING LINEMARKING, SIGNS KERB AND CONCRETE.
- APPLY NEW LINEMARKING AND INSTALL NEW KERB, CONCRETE AND SIGNS.

Scale

0m 10m 20m 30m
SCALE: A1 1:500, A3 1:1000

Design Agent

Designed by BVA
Drawn by BVA
Checked by HGS
Approved by PP

Client

Project Officer: Peter Toit
Project Number: 18A



Project

**BLACKSPOT PROGRAM
NAMATAJIRA DR /
STRETON DR**

Scale: AS SHOWN
Date: 27/4/09

Drawing Title

**OPTION A
REMOVAL OF BICYCLE LANE**

Dwg. No. **RG 00035**
Sheet **601**
Revision **0**

